

iNX 60

Order number:
iNX1L057X040NBAIX

Characteristic	Abbr.	Unit	Value
Motor technology			SPM
Frame size		mm	60
Module Length			1U
No of poles			10
Feedback			18 bits absolute
Brake			No
Temperature sensor			PT1000
Bus voltage	U_{bus}	V_{DC}	48-58
Rated Voltage	U_{mot}	V_{rms}	48
Rated speed	n_n	rpm	3,000
Maximum speed	n_{max}	rpm	4,900
Rated power	P_n	W	200
Stall torque	M_0	Nm	0.6
Rated torque	M_n	Nm	0.6
Peak torque	M_{max}	Nm	1.8
Stall current	I_0	A_{rms}	4
Rated current	I_n	A_{rms}	4
Peak current	I_{max}	A_{rms}	12.5

Characteristic	Abbr.	Unit	Value
Torque constant (hot)	kt_{hot}	Nm/A_{rms}	0.14
Torque constant (cold)	kt_{cold}	Nm/A_{rms}	0.15
Voltage constant	ke	$V/krpm$	9.6
Winding resistance	R_{p-p}	Ω	0.95
Winding inductance	L_{p-p}	mH	1.44
Cogging torque	ct	%	3
Weight	m	kg	0.8
Moment of inertia rotor	J	$kg\cdot cm^2$	0.15
Max ambient operating temperature			40°C
Insulation class			F – 155°C
Protection class			IP65
Cooling			N/A
Bearing life		hrs	> 20,000

Motor performance

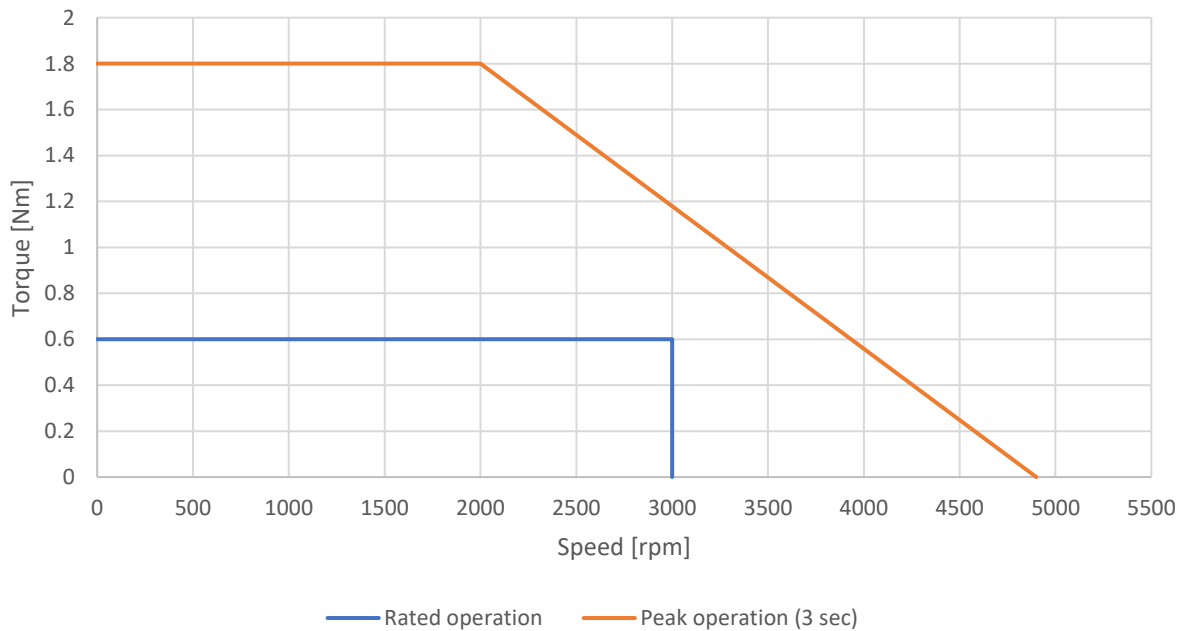



Motor dimensions

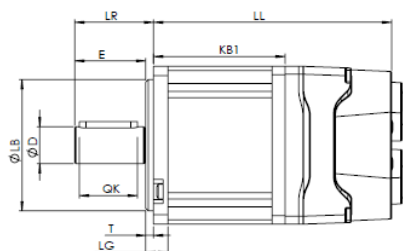
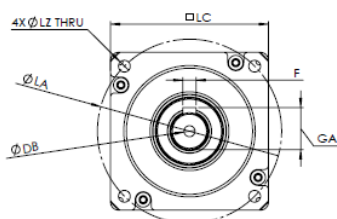
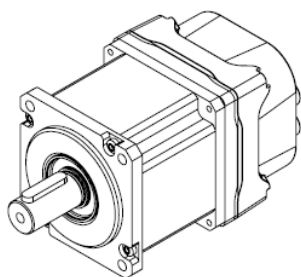

FOR MOTORS DIMENSIONS IN MM									DE SHAFT EXTENSION					WITHOUT BRAKE		WITH DRIVE					
SHAFT HEIGHT	SEGMENT LENGTH	LC	LA	LZ	LB	LR	T	LG	D	DB	E	QK	GA	F	LL	KB1	LL	KB1	KB2	KL1	KL2
15	1U	60	70	4.5	50	30	3	8.5	14	M5X0.8	27	22	16	5	-	-	90.52	50	-	-	-
15	2U	60	70	4.5	50	30	3	8.5	14	M5X0.8	27	22	16	5	-	-	110.52	70	-	-	-
15	3U	60	70	4.5	50	30	3	8.5	14	M5X0.8	27	22	16	5	-	-	130.52	90	-	-	-